

GUND (Geoid Undulation) = The height of the Geoid (MSL) above the Reference Ellipsoid (WGS 84) at the stated position.	
BEARINGS ARE MAGNETIC ELEVATIONS AND HEIGHTS ARE IN FEET	102
ELEVATIONS IN FEET AMSL HEIGHTS IN FEET ABOVE AD	

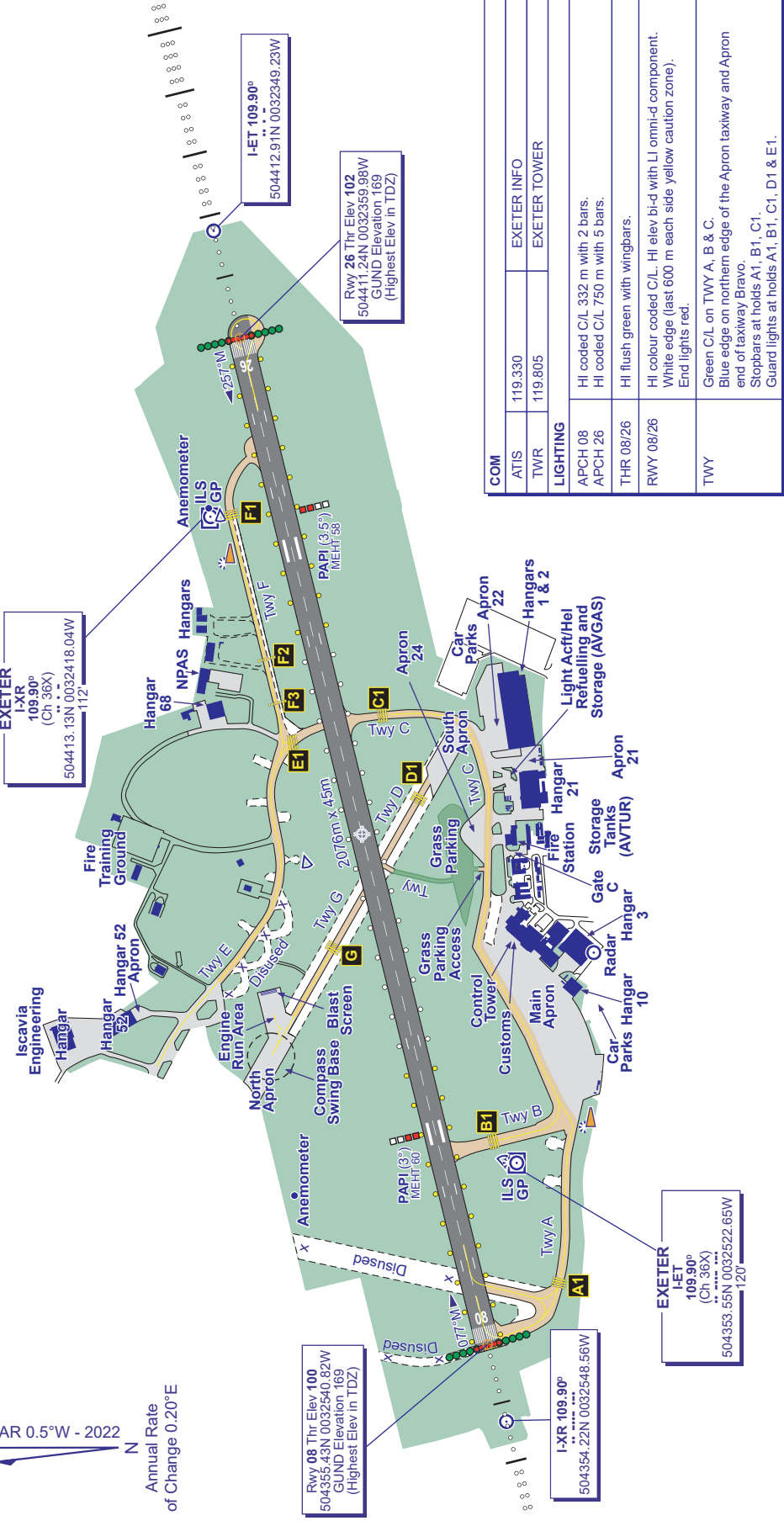

EXETER
I-XR
109.90°
(Ch 36X)
504413.13N 0032418.04W
112°



RUNWAY/TAXIWAY/APRON PHYSICAL CHARACTERISTICS	
RWY / TWY / APRON	SURFACE
RWY 08/26	Grooved Asphalt
TWY A, C, D, G	Asphalt
TWY B	Concrete
TWY E	Asphalt
TWY F	Asphalt
Apron (All)	Asphalt
See AD 2-EGTE-2-2	

COM	
ATIS	119.330
TWR	119.805
EXETER INFO	
EXETER TOWER	

LIGHTING	
APCH 08	HI coded C/L 332 m with 2 bars.
APCH 26	HI coded C/L 750 m with 5 bars.
THR 08/26	HI flush green with wingbars.
RWY 08/26	HI colour coded C/L. HI elev bi-d with LI omni-d component. White edge (last 600 m each side yellow caution zone). End lights red.
TWY	Green C/L on TWY A, B & C. Blue edge on northern edge of the Apron taxiway and Apron end of taxiway Bravo. Stopbars at holds A1, B1, C1. Guard lights at holds A1, B1, C1, D1 & E1.